

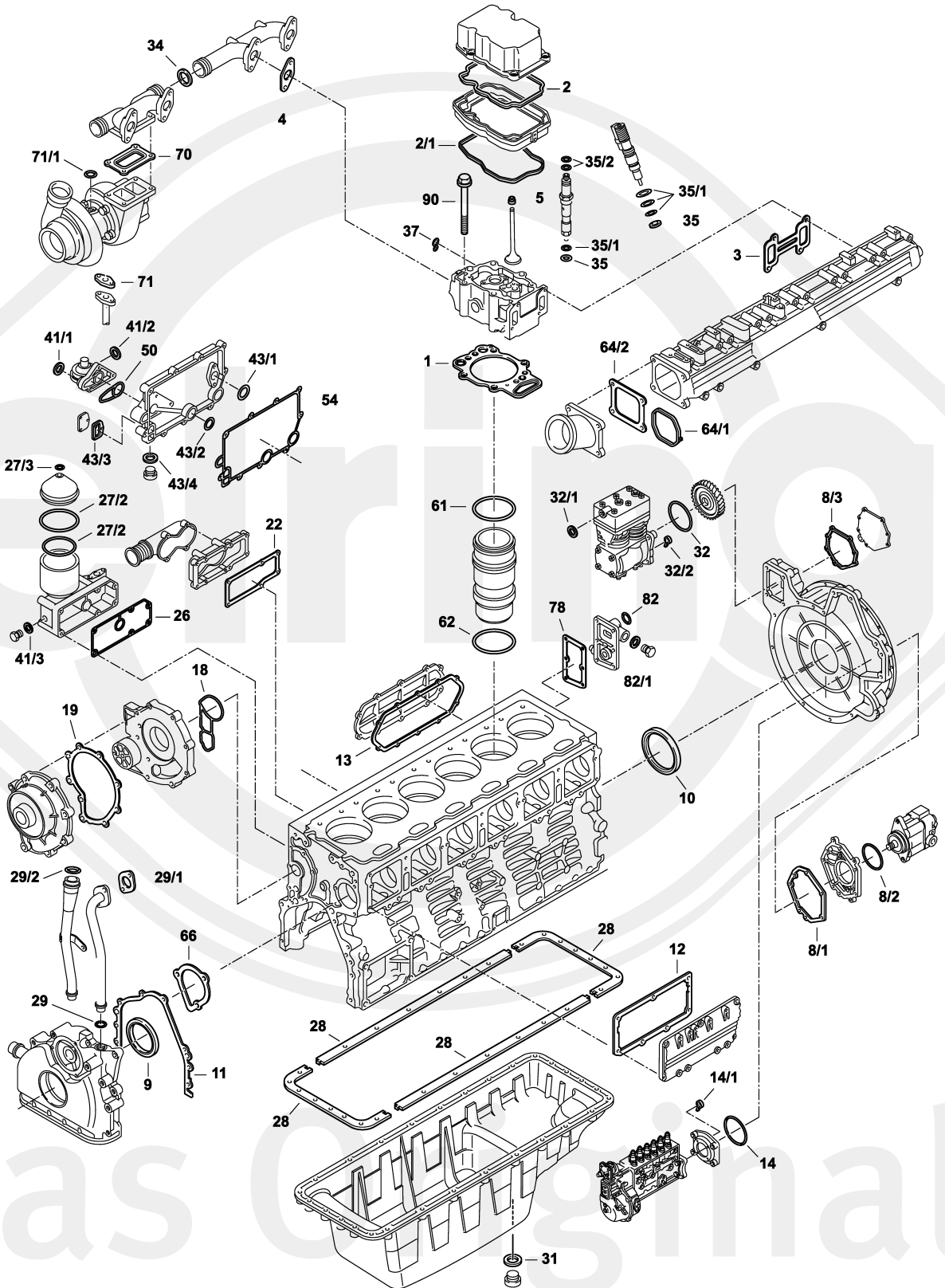

Das Original

Scania

DC 11 | D 12



Das Original



DC 11 | DC 12 | DT 12 | DSC 12

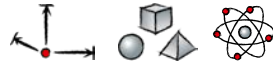

S ⊕*	159.690	1x	551 356 + 1 392 708	–	→ 6 119 599 SSS → 8 004 779 SLA
S ⊕*	159.640	1x	551 386 + 1 392 708	incl. OKD 157.540 & 570.300	6 119 600 SSS → 8 004 780 SLA →
S ⊕*	733.800	1x	–	–	Serie P, R, T D11 D12
S ⊕*	755.300	1x	–	–	Serie P, G, R, T DC12.18/22
ES ⊕	138.500	6x	551 363 + 1 328 563 (4x)	–	→ 6 119 599 SSS → 8 004 779 SLA
ES ⊕	138.490	6x	550 469 + 1 328 563 (4x)	–	DC11 01/02/03/04/06 DSC12 05 DC12 DT12 D12 6 119 600 SSS → 8 004 780 SLA →
ES	374.190	6x	551 350	–	DSC12 01/02 → 5740731 SSS → 3125405 SLA
ES	379.320	6x	1 725 112	–	125.830 Serie P, R, T D11 D12
ES	798.690	6x	–	–	247.490
OKS	594.580	1x	–	–	incl. OKD 570.300
OKS	801.460	1x	–	–	incl. OKD 382.002
LBS	199.471	6x	–	–	incl. 1x126.001; 1x 126.010
ZKS	125.990	6x	1 451 946 (6x)	M 16x2x189	–
1	125.780	6x	1 444 941	–	DSC 12 01/02 → 6 119 599 SSS → 8 004 779 SLA
1	125.830	6x	1 468 555	∅ 133 mm VMQ	DC 11 DC 12 DT 12 DSC 01/02 6 119 600 SSS → 8 004 780 SLA → DSC 12 03/05
1	247.491	6x	1 893 054	∅ 133 mm FPM	HPI, PDE Gen.I
2	125.870	6x	1 367 028	–	DSC 12 01/02 → 6 119 599 SSS → 8 004 779 SLA





DC 11 | DC 12 | DT 12 | DSC 12

			#				
2	060.660	6x	1 414 422	-			DSC 12 01/02  6 119 600 SSS →  8 004 780 SLA →
2	125.840	6x	1 401 984	-			DSC 12 03/05 →  5 731 918
2	060.600	6x	1 411 851	-			DSC 12 03/05  5 731 919 → DC 11 DC 12 DT 12
2/1	060.710	6x	1 367 027	-			DSC 12 01/02 →  6 119 599 SSS →  8 004 779 SLA
2/1	060.620	6x	1 476 506	-			DC 11 DC 12 DT 12 DSC 01/02  6 119 600 SSS →  8 004 780 SLA → SC 12 03/05
3	152.140	6x	1 516 474	-			-
4	135.020	6x	1 309 051	-			-
5	125.771	24x	1 920 860	10x12,4/16,2x9,5 FPM			-
8/1		1x	1 467 988	EWP/soft material			-
8/1	058.590	1x	1 461 331	Elastomer/Rubber/Caoutchouc/ Goma			-
8/2	919.241	1x	368 035	64,5x3 VMQ RD			-
8/3	136.930	1x	1 374 327	-			-
9	152.320	1x	1 392 708	120x140x12 RD PTFE/ACM			-
10	090.510	1x	1 433 183	145x175x13 LD PTFE/ACM			-
10	904.820	1x	1 757 903	145x185x13 LD PTFE/ACM			-
11		1x	1 374 334	-			DSC 12 01/02 →  5 719 204
11		1x	1 403 129	-			DSC 01/02  5 719 205 →
11	138.590	1x	1 423 290	-			 
12	136.990	3x	1 374 326	-			-
13	137.010	1x	1 375 383	-			-
14	135.000	1x	1 332 328	178x3 FPM RD			-
14/1	156.841	2x	1 871 043	-			-
18	156.850	1x	1 403 883	-			-
19	138.451	1x	1 541 633	-			-

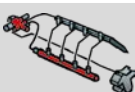

DC 11 | DC 12 | DT 12 | DSC 12

			#	  	
20	-	1x	1 338 040	-	-
22	136.920	1x	1 374 333	-	-
23	-	1x	1 421 825	-	-
26	136.580	1x	1 382 187	-	-
27/2	281.906	1x	372 985	132,94x3,53 ACM RD	-
27/2	000.924	1x	1 769 798	110,7x4 ACM RD	-
27/3		1x	372 983	10,8x2,62 FPM RD	-
28	175.024	1x	1 865 674	-	→  6 391 149 SSS →  8 114 919 SLA
29	-	1x	1 403 128	-	-
29		1x	804 662	24,2x3 NBR RD	-
29/1	-	1x	1 401 985	-	-
29/2		1x	804 670	44,2x3 NBR RD	-
31	154.080	1x	1 423 610	24,2x36x3 FE/FPM	-
32	919.226	1x	323 790	114,5x3 FPM RD	-
32/1	804.360	1x	1 373 794	18,7x26x1,5 FE/FPM	-
32/2		1x	1 376 911	-	-
34	584.830	4x	1 408 455	-	-
35	002.194	6x	1 421 424	9,6x19,7x2 CU A	-
35/1	136.880	6x	1 422 564	-	
35/1	135.010	18x	1 340 615	18,1x1,6 FPM RD	
35/2	135.010	18x	1 340 615	18,1x1,6 FPM RD	
37	130.031	6x	1 368 061	-	-
41/1	114.600	1x	812 414	14x18x1,5 CU A	-
41/2	153.290	1x	1 373 793	16,7x24x1,5 FE/FPM	-
41/3	128.503	1x	812 418	22x27x1,5 CU A	-
43/1	138.290	2x	1 352 886	-	-
43/2	136.790	2x	1 352 885	Ø 34 mm FPM	-
43/3		1x	1 391 726	-	-
43/4	128.503	1x	812 418	22x27x1,5 CU A	-
50	136.570	1x	1 367 849	-	-



DC 11 | DC 12 | DT 12 | DSC 12

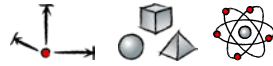

51	138.440	1x	1 510 331	-	
54	157.540	1x	1 349 497	Elastomer/Rubber/Caoutchouc/ Goma	-> 6106282 SSS -> 3138144 SLA
54	570.300	1x	1 502 798	Elastomer/Rubber/Caoutchouc/ Goma	6106283 -> -> 6357163 SSS 6357771 -> -> 6368386 SSS 3138145 SLA ->
54	382.002	1x	2 096 560	-	6357164 -> -> 6357770 6368387 SSS ->
61	126.001	6x	2 071 088	144x2,5 FPM RD	-
61	743.401	6x	2 188 199	142,5x3,35 FPM RD	-
62	126.010	6x	1 328 995	147,5x4 EPDM RD	-
64/1	138.280	1x	1 390 211	-	-
64/2	136.440	1x	1 374 342	-	-
66	136.490	1x	1 375 387	-	-
70	359.321	1x	1 393 937	-	Serie 4
70	794.670	1x	2 137 185	MLS	Serie P, R, T
71		2x	1 511 652	-	-
71/1	118.907	1x	812 415	16x20x1,5 CU A	-
78		1x	1 374 325	EWP/soft material	-
78	559.100	1x	1 500 216	Elastomer/Rubber/Caoutchouc/ Goma	-
82	742.767	1x	393 187	11,3x2,4 NBR RD	-
82/1	153.260	1x	1 374 839	22,7x30x2 FE/FPM	-